

Kensington®

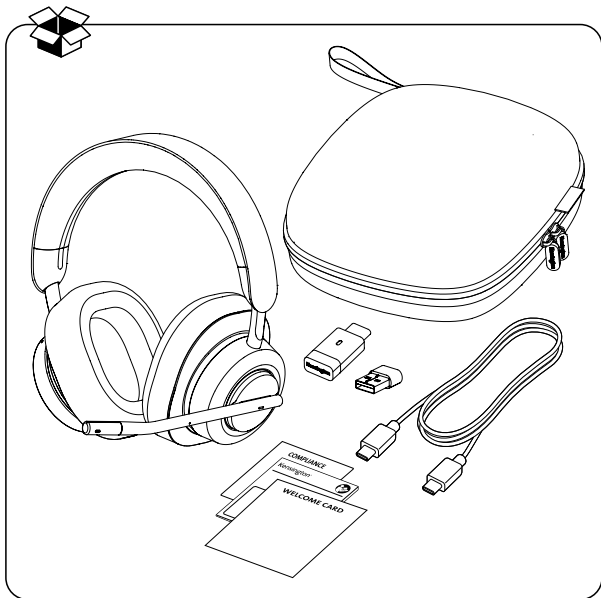

H3000 Bluetooth® Headset – Over Ear H3000 藍芽™耳罩式耳機



kensington.com/register

1

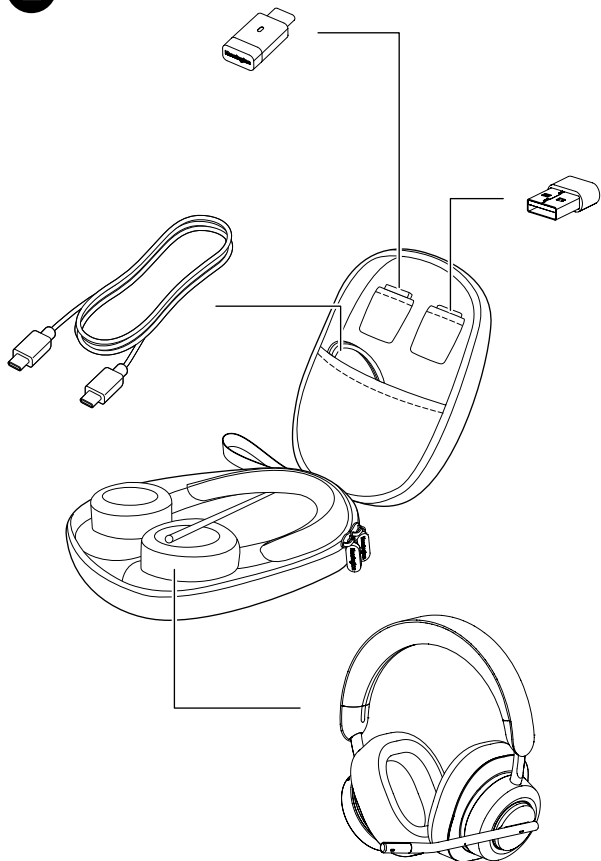

2

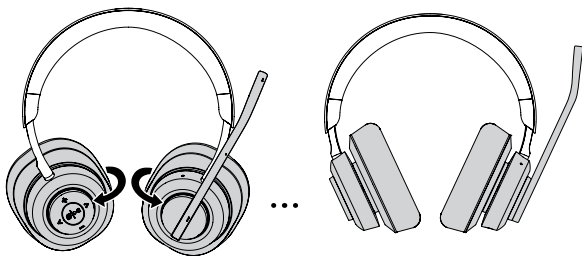

3

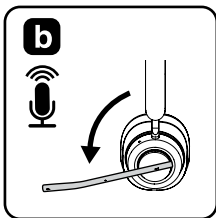
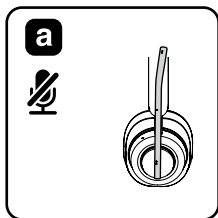

Power on | Mise sous tension |
Einschalten | Accensione |
Encendido | Ligado | التشغيل |
電源オン | 开机 | 開機



Power off | Éteindre |
Ausschalten | Spegni | Apagar |
Desligar | انقطاع التيار الكهربائي |
電源オフ | 关机 | 關機



Bluetooth pairing | Appairage Bluetooth |
Bluetooth-Kopplung |
Abbinamento Bluetooth |
Emparejamiento por Bluetooth |
Emparelhamento Bluetooth |

الاتزان عبر البلوتوث | Bluetooth のペアリング中 |
藍牙配对 | 藍牙配對



Voice assistance | Assistant vocal |
Sprachassistent | Assistente vocale |
Asistente de voz | Assistente de voz |
مساعد الصوت | 音声アシスト | 语音助手 |
語音助理

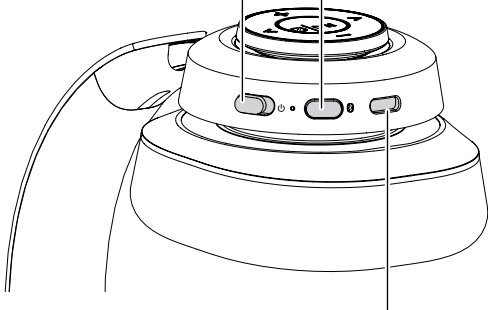

USB-C charge | Charge USB-C | Ladevorgang über USB-C |
Carica USB di tipo C | Carga USB-C | Carregamento por USB-C |
USB-C شحن | USB-C 充電 | USB-C 充电 | USB-C 充電

5

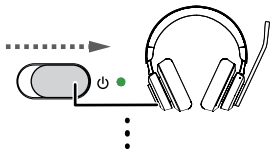

USB-C

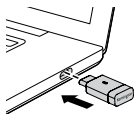

USB-A

a

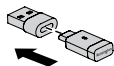

b

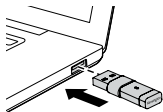

or

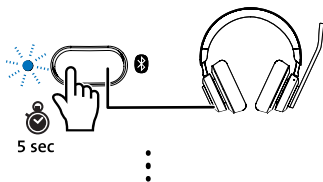

 H3000 Headset

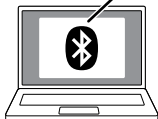



Next track | Piste suivante | Nächster Titel |
Traccia successiva | Siguiente pista | Faixa seguinte |
المسار التالي | 次のトラック | 下一曲 | 下一首



Previous track | Piste précédente | Vorheriger Titel |
Traccia precedente | Pista anterior | Faixa anterior |
المسار السابق | 前のトラック | 上一曲 | 上一首



Volume up | Volume haut | Lautstärke erhöhen |
Volume + | Subir volumen | Aumentar o volume |
رفع مستوى الصوت | 音量を上げる | 调高音量 | 調高音量



Volume down | Volume bas | Lautstärke verringern |
Volume - | Bajar volumen | Diminuir o volume |
خفض مستوى الصوت | 音量を下げる | 调低音量 | 調低音量



•••

Music play & Pause | Lecture de la musique et Pause |
Musikwiedergabe und Pause | Riproduci e interrompi
musica | Reproducción de música y pausa | Reprodução
de música e pausa | تشغيل الموسيقى وإيقافها مؤقتًا | 音樂再生と
一時停止 | 音乐播放和暂停 | 音樂播放與暫停



•••

Sidetone on/off | Tonalité latérale activée/désactivée |
Mithörton ein/aus | Attivazione/disattivazione del tono
laterale | Activar/desactivar tono lateral | Ativar/
desativar tom lateral | نغمة جانبية تشغيل / إيقاف |
サイドトーンのオン/オフ | 側音开/关 | 側音開/關 | 側音開啟/關閉

In solid red | Rouge fixe | Leuchtet rot | Luce rossa fissa | Rojo fijo |
 Em vermelho fixo | بلون أحمر سادة | 赤で点灯 | 红灯长亮 | 紅燈長亮



...



Flash in red | Clignote en rouge | Blinkt rot | Lampeggiante di rosso |
 Parpadeo en rojo | Pisca em cor vermelha | فلاش باللون الأحمر | 赤で点滅 | 红灯闪烁 |
 紅燈閃爍



...



...



8



...



...



...



9

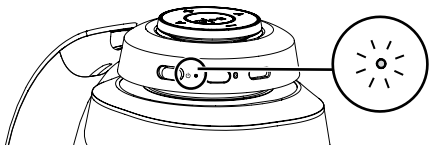

Power on: Solid blue for 3 secs | Mise sous tension : Bleu fixe pendant 3 secondes | Eingeschaltet: Durchgehend blau für 3 Sekunden | Accensione: Blu fissa per 3 secondi | Encendido: Azul sólido durante 3 segundos | Ligado: Azul fijo durante 3 s | التشغيل: أزرق ثابت لمدة 3 ثوان | 電源オン:3秒間青色に点灯 | 通电: 蓝灯会长亮 3 秒 | 開啟電源: 藍色長亮 3 秒



Fully-charged: In solid green | Charge complète: Vert fixe |
Akku vollständig geladen: Leuchtet grün | Completamente carico :
Luce verde fissa | Carga completa: Verde fijo |
Completamente carregado: Em cor verde fixa | بلون أخضر سادة |
フル充電: 緑で点灯 | 已充满电: 绿灯长亮 | 電源充飽: 綠燈長亮



Charging: Slow breathing in red | En charge: Clignotement lent en rouge |
Aufladen: Pulsiert langsam rot | Ricarica: Lampeggia lentamente di rosso |
Carga: Parpadeo lento en rojo | Em carregamento: A luz vermelha pisca lentamente |
الشحن: وميض بطيء باللون الأحمر | 充電中: 赤でゆっくり点滅 | 充電中: 紅燈慢閃 |
充電中: 紅色呼吸燈



Low battery (<10%): Flash in red | Batterie faible (< 10 %):
Clignote en rouge | Akku schwach (<10 %): Blinkt rot |
Batteria scarica (<10%): Lampeggiante di rosso | Bateria baja (<10 %):
Parpadeo en rojo | Bateria fraca (<10%): Pisca em cor vermelha |
البطارية منخفضة (>10%): فلاش باللون الأحمر | 低バッテリー残量(10%未満): 赤で点滅 |
電池電量低(<10%): 紅燈閃爍 | 低電量(<10%): 紅色閃燈



Bluetooth® not connected: Flash in Red/Blue alternately |
Bluetooth® non connecté: Clignote en rouge/
bleu alternativement | Keine Bluetooth®-Verbindung:
Blinkt abwechselnd rot/blau | Bluetooth® non
collegato: Lampeggia alternativamente di rosso e blu |
Bluetooth® no conectado: Parpadeo en rojo y azul
alternativamente | Bluetooth® desligado: Pisca em cor
vermelha/azul alternadamente |
البلوتوث غير متصل: الفلاش باللون الأحمر/الأزرق بالتناوب |
Bluetooth® が未接続: 赤/青交互に点滅 | 蓝牙未连接: 紅燈/
藍燈交替閃爍 | 藍牙未連接: 紅燈/藍燈交替閃爍



Enter pairing mode: Fast flash in Blue | Entrer en mode d'appairage:
Clignote rapidement en bleu | Kopplungsmodus aktiviert: Blinkt
schnell blau | Accedere alla modalità di abbinamento: Lampeggiante
rapidamente di blu | Entrada en el modo de emparejamiento:
Parpadeo rápido en azul | Aceder modo de emparelhamento: Pisca
rápido em cor azul | الدخول إلى وضع الاقتران: فلاش سريع باللون الأزرق |
ペアリングモード: 青で速く点滅 | 进入配对模式: 藍燈快閃 |
進入配對模式: 藍燈快閃



Bluetooth® connected: Flash in blue | Bluetooth® connecté:
Clignote en bleu | Bluetooth®-Verbindung erfolgreich hergestellt:
Blinkt blau | Bluetooth® collegato: Lampeggiante di blu | Bluetooth®
conectado: Parpadeo en azul | Bluetooth® ligado: Pisca em cor azul |
البلوتوث متصل: فلاش باللون الأزرق | Bluetooth® に接続: 青で点滅 |
藍牙已连接: 蓝灯闪烁 | 藍牙已連接: 藍燈閃爍

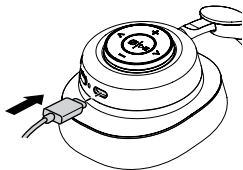

⋮

USB-C

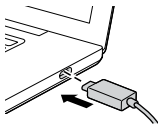

USB-A

a

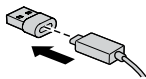

b

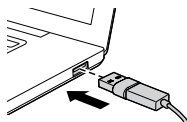

⋮

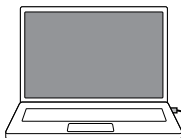

5V/0.6A

15 min →



8 hrs

90 min →



100%



www.kensington.com/support



Australia	1300 881 931	México	55 15 00 57 00
België / Belgique	02 401 2395	Nederland	010 713 1882
Brasil	14 3235-4003	New Zealand	0800 539 26273
Canada	1 800 268 3447	Norway	80017520
中国	400 600 4599	Österreich	0800 677 873
Denmark	80 250966	Polska	22 570 18 00
Deutschland	+49 711 70740074	Portugal	800855802
España	911 146 735	Россия	007 495 933 5163
Finland	0800 9 15697	Schweiz / Suisse	044 580 6667
France	01 7671 0404	Singapore	+65-6776-0195
Hong Kong	00852 2823 5130	Sweden	08 5033 6577
Hungary	06 20 9430 612	United Kingdom	0203 364 5390
Ireland	01 431 1395	United States	1 800 535 4242
Italia	02 3604 7030	International Toll	+44 203 364 5390
Japan	+81 04-7129-2135		

Kensington and the ACCO name and design are registered trademarks of ACCO Brands. Mac and the Mac logo are trademarks of Apple Computer, Inc. registered in the U.S. and other countries. Windows is a registered trademark of Microsoft Corporation in the U.S. and/or other countries. Chrome is a trademark of Google Inc. USB-C is a trademark of USB Implementers Forum. All other registered and unregistered trademarks are the property of their respective owners. © 2022 Kensington Computer Products Group, a division of ACCO Brands.

Model number: M01584-H, M01584-D

RF TECHNICAL SPECIFICATION

Operating Frequency Range: 2402~2480 GHz

Maximum RF Output Power: 0dBm~8dBm

