

PML9009/PML9019
PML9049/PML9059
Series

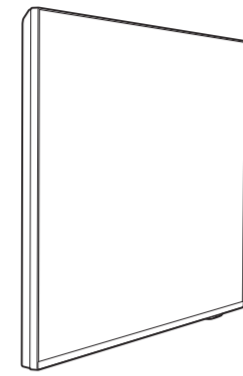

9009/9019

55"/65"

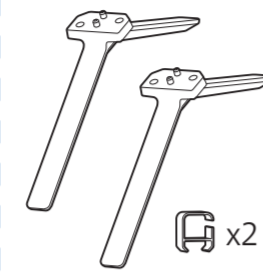

x2

75"

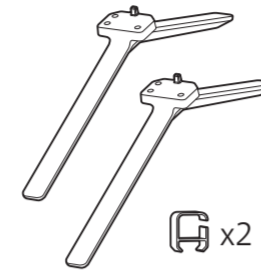

x2

85"

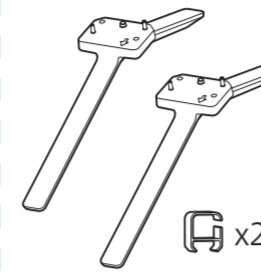

x2

9049/9059

55"/65"

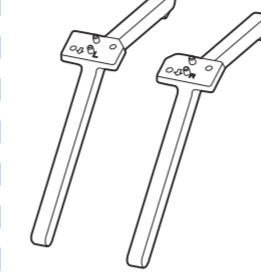

75"

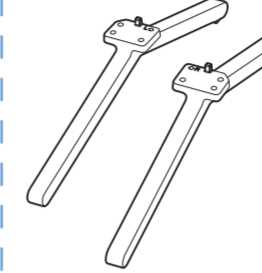

85"

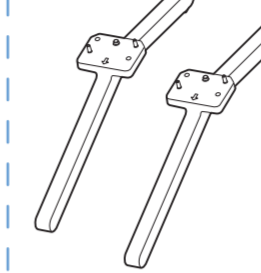

A

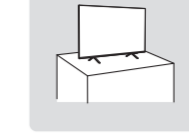

B

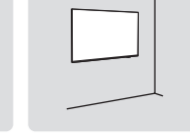

Register to find out more and get support
www.philips.com/TVsupport

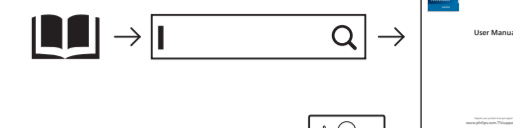

(EU) (UK)

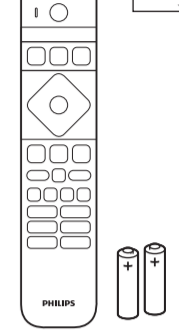
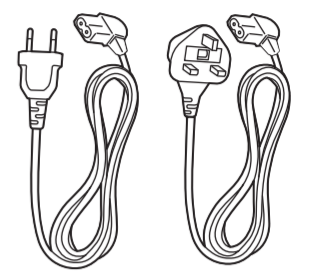

55"/65" (M4xL20) : x4
75" (M5xL22) : x6
85" (M5xL20) : x4

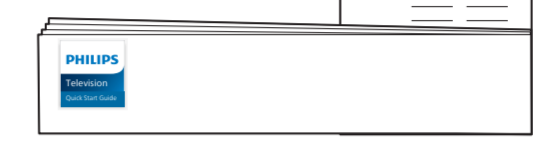

A 55"

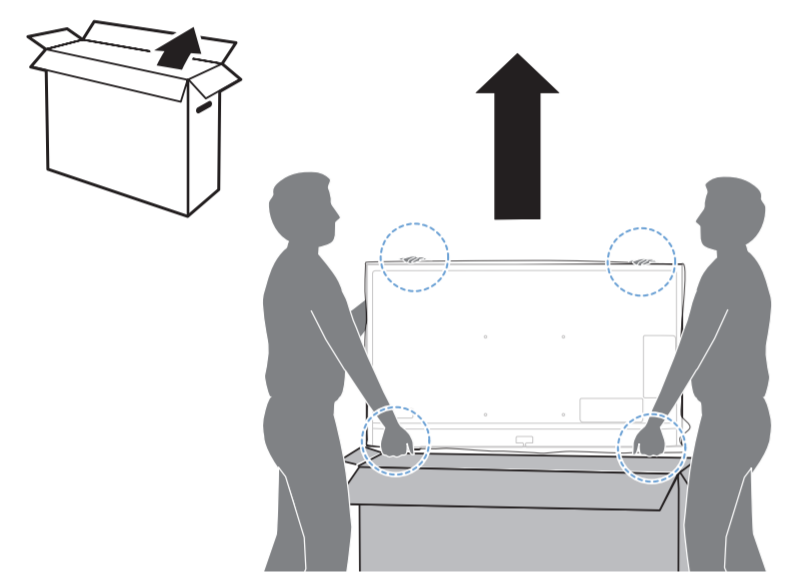

65"/75"/85"

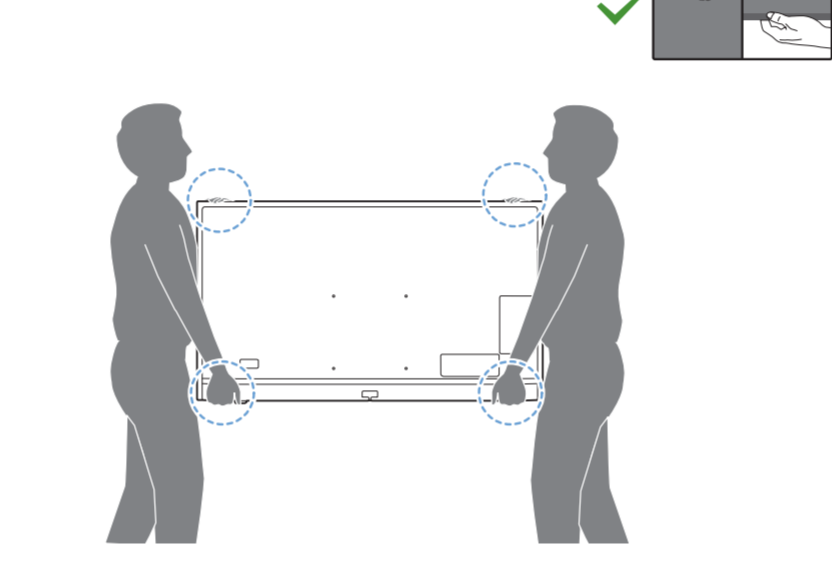
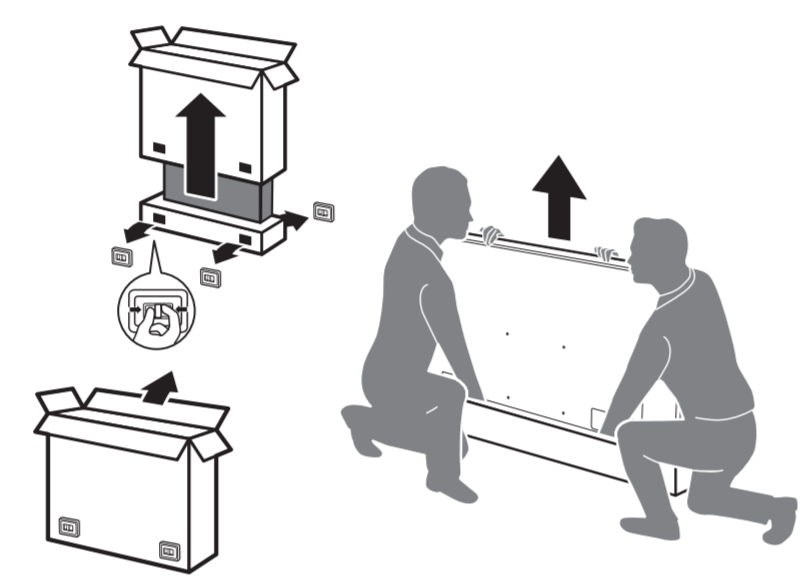

1

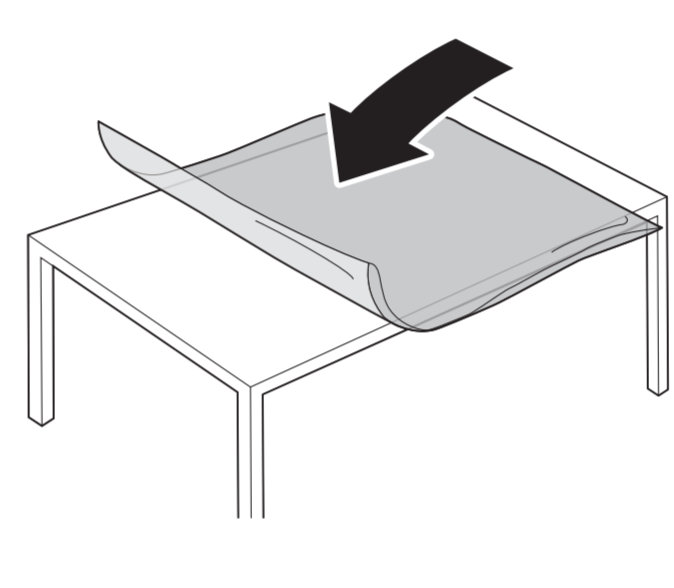

B

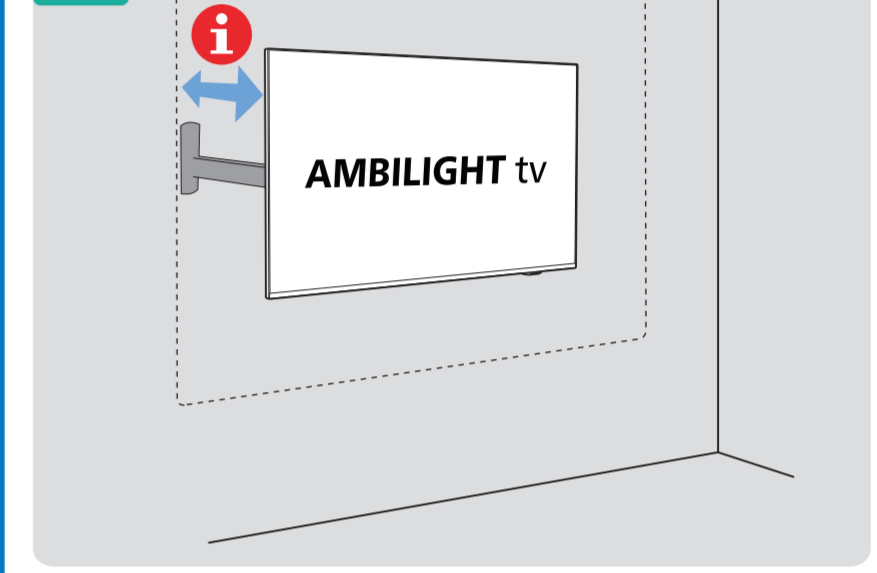

2

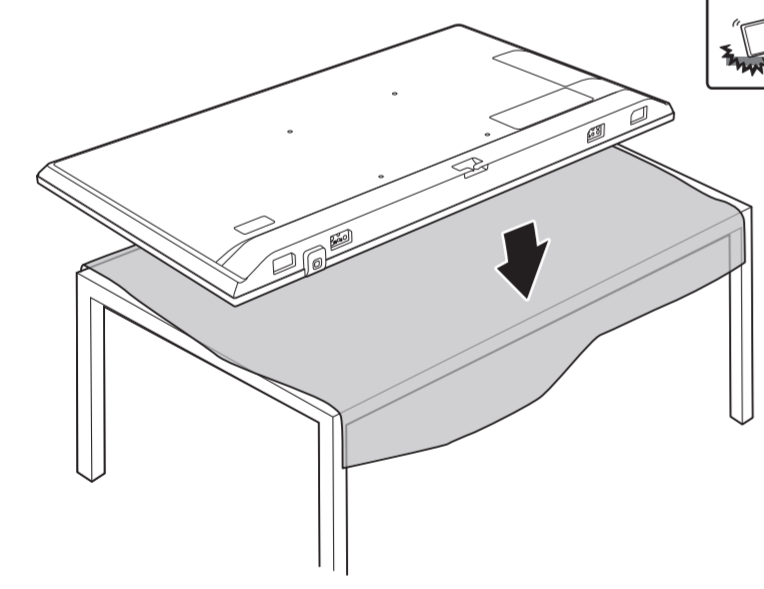

3

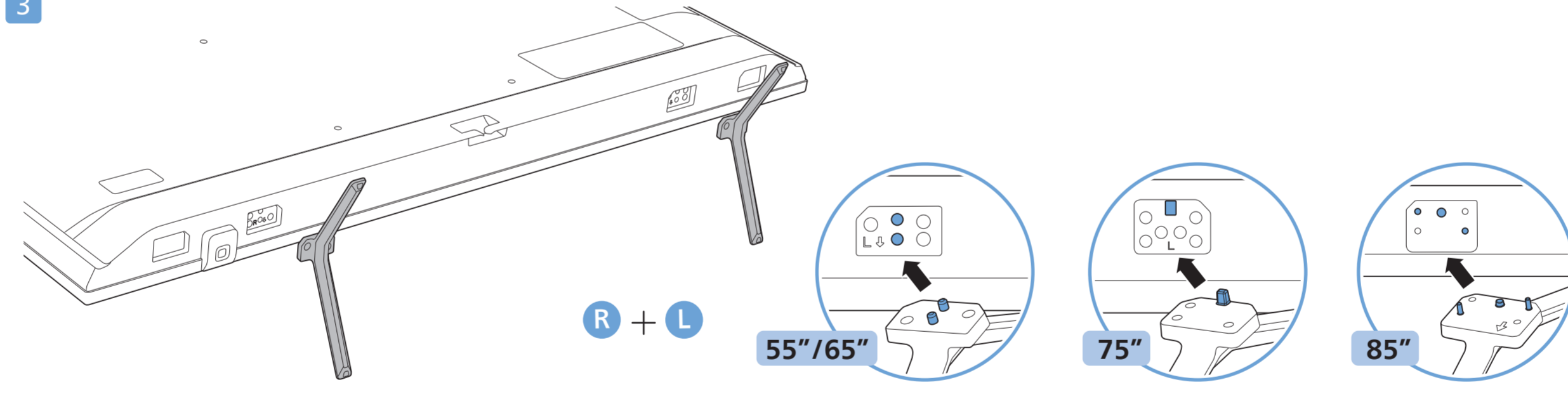

R + L

55"/65"

75"

85"

1

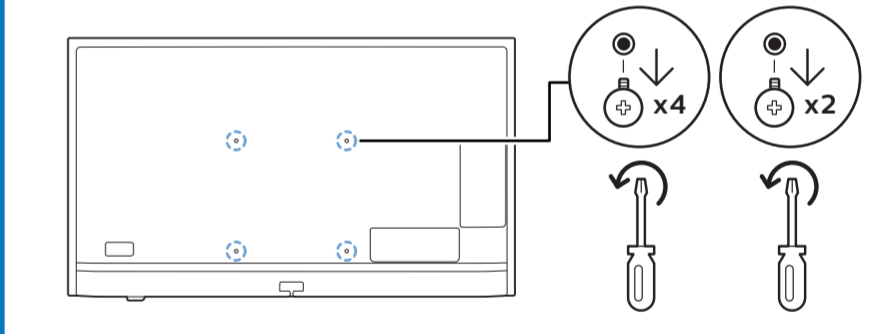

2 Wall Mount dimensions (x, y)
Dimensioni del montaggio a parete (x, y)

- 55" 300x300mm M6 (L: 14mm~18mm) 139 cm
- 65" 300x300mm M6 (L: 14mm~18mm) 164 cm
- 75" 300x300mm M8 (L: 12mm~25mm) 194 cm
- 85" 600x400mm M8 (L: 24mm~28mm) 215 cm

4 55"/65"/75"/85"

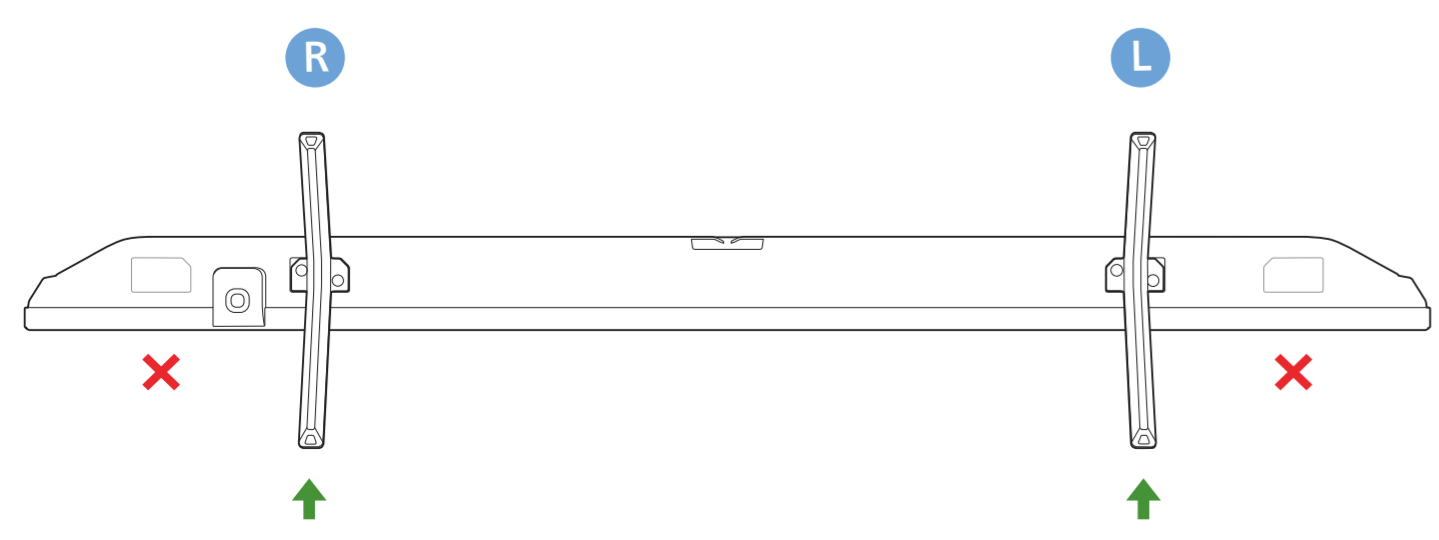

R + L

55"/65"
85"

75"

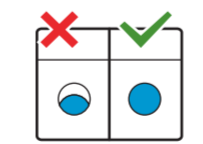

5

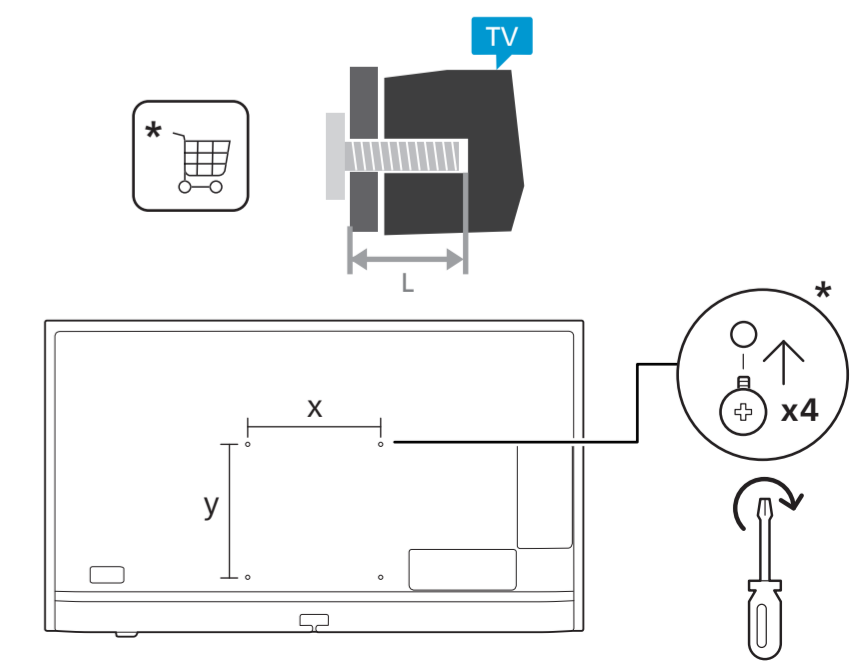
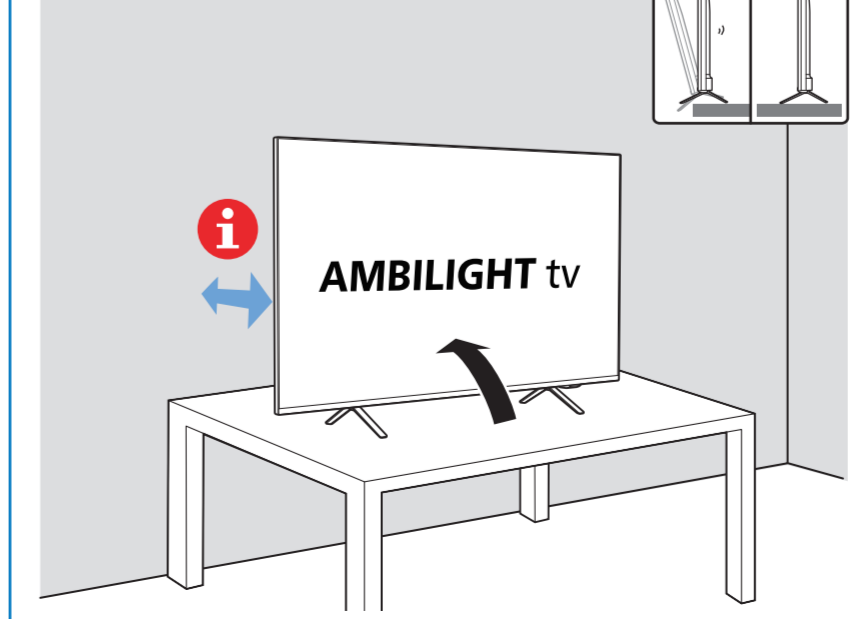



9009/9019

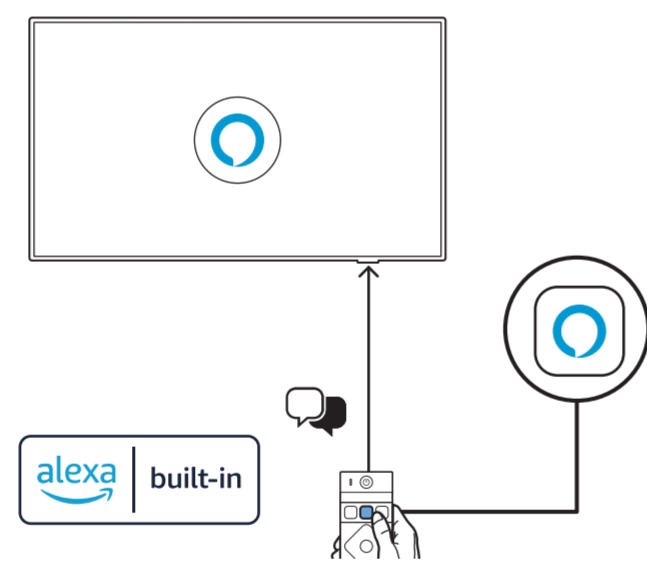
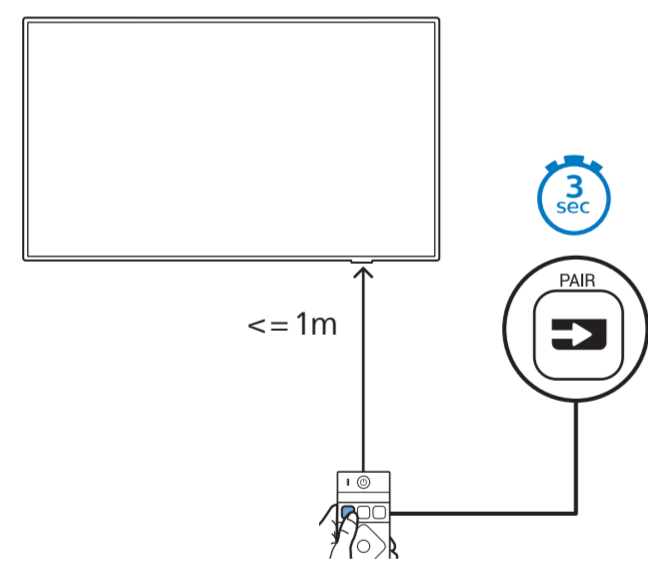
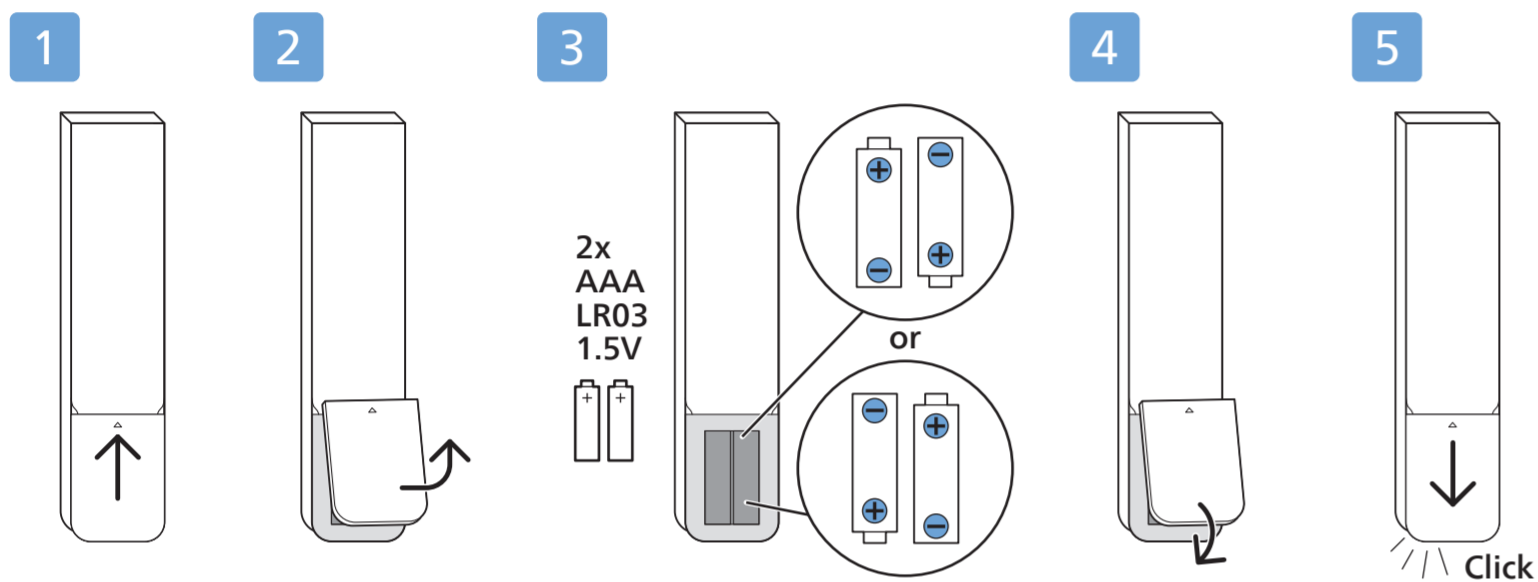
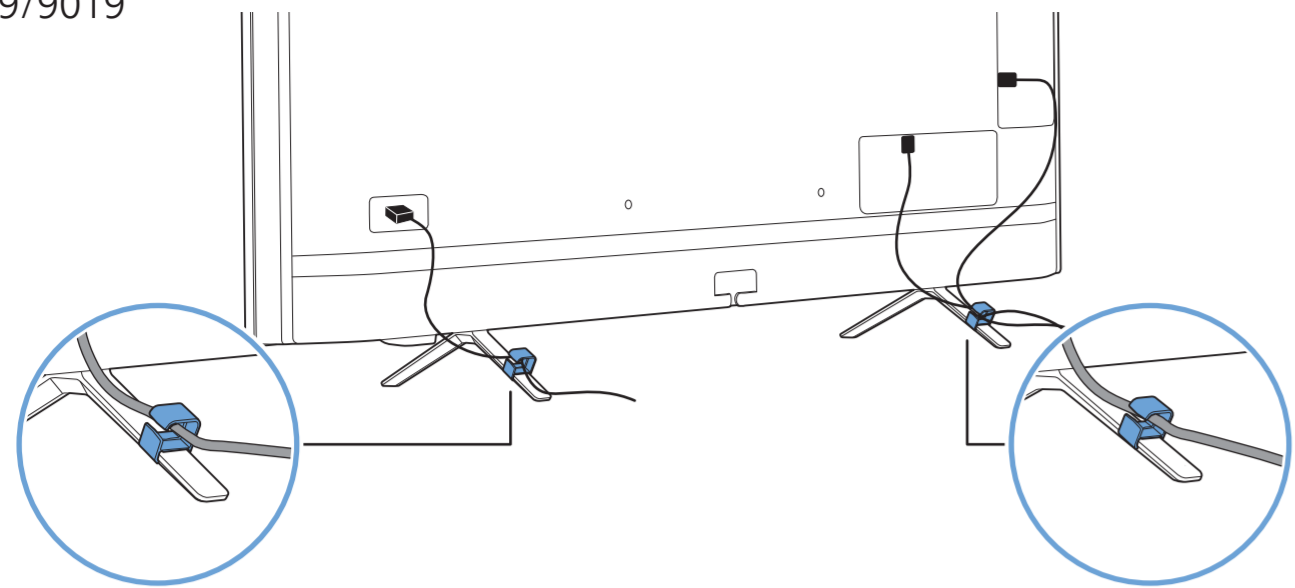

English Read the safety instructions.
Български Прочетете инструкциите за безопасност.
Čeština Přečtěte si bezpečnostní pokyny.
Hrvatski Pročitajte sigurnosne upute.
Dansk Læs sikkerhedsforskrifterne.
Deutsch Lesen Sie die Sicherheitshinweise.
Ελληνικά Διαβάστε τις οδηγίες ασφαλείας.
Eesti Lugege ohutusnõudeid.

Spanish Lea las instrucciones de seguridad.
Français Lisez les consignes de sécurité.
Italiano Leggere le istruzioni di sicurezza.
Kazakша Қорғаныстық нұсқаулар.
Latviešu Izlasiet drošības norādījumus.
Lietuvių Perskaitykite saugos instrukcijas.
Magyar Olvassa el a biztonsági utasításokat.
Nederlands Lees de veiligheidsvoorschriften.
Norsk Les sikkerhetsforskriftene.

Polski Zapoznaj się z instrukcjami bezpieczeństwa.
Português Leia as instruções de segurança.
Română Cititi instrucțiunile de siguranță.
Русский Читайте инструкции по технике безопасности.
Srpski Pročitajte bezbednosna uputstva.
Slovenščina Preberite varnostna navodila.
Slovenský Prečítajte si bezpečnostné pokyny.
Suomi Lue turvaohjeet.

Svenska Läs säkerhetsinstruktionerna.
ไทย โปรดอ่านคำแนะนำด้านความปลอดภัย.
Türkçe Güvenlik talimatlarını okuyun.
Українська Читайте інструкції з техніки безпеки.
العربية قراءة تعليمات السلامة.
עברית קרא את הוראות הבטיחות

FSC Logo H:12mm

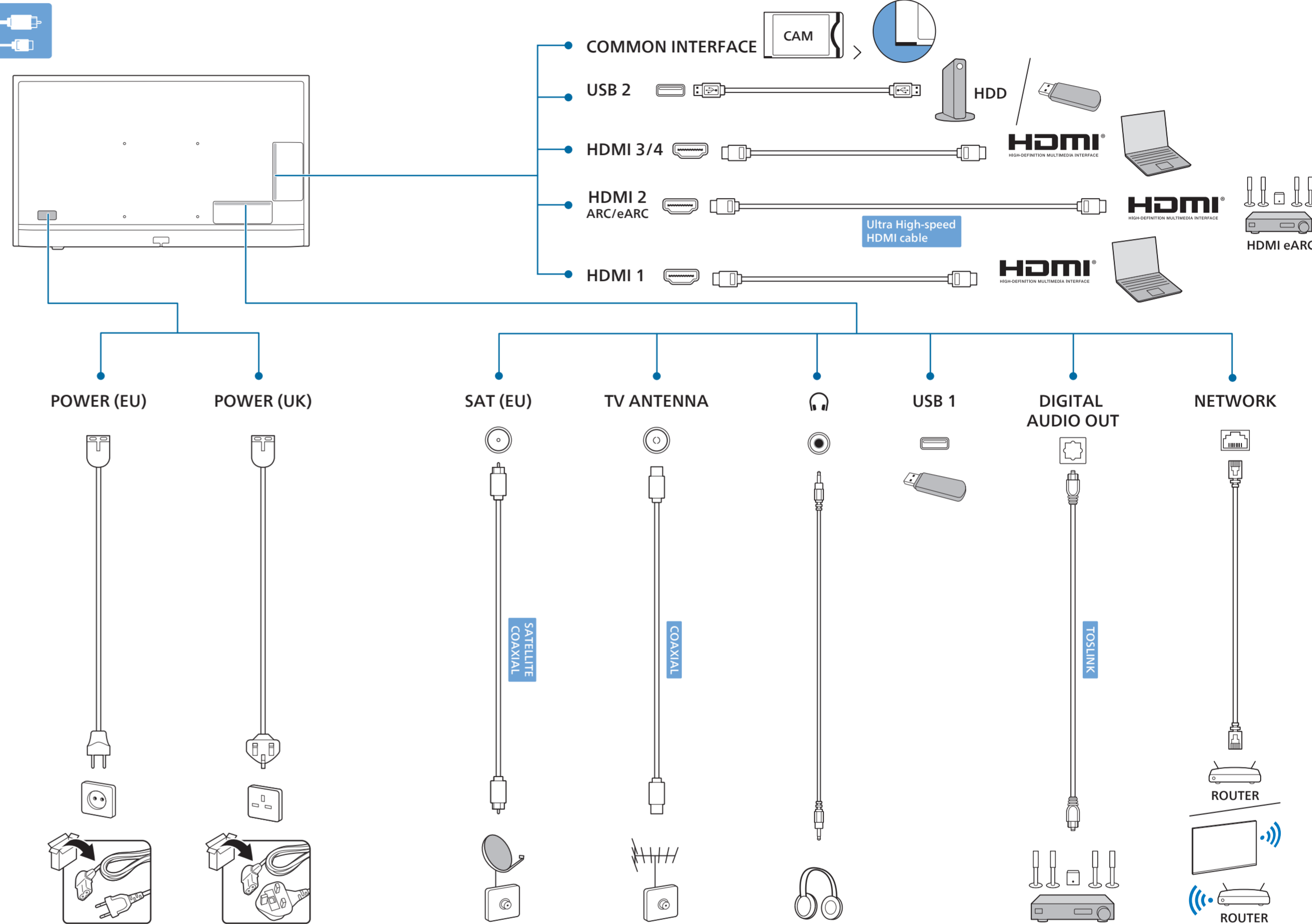
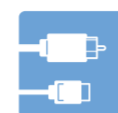
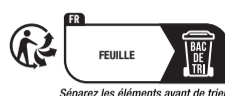

AMBILIGHT tv

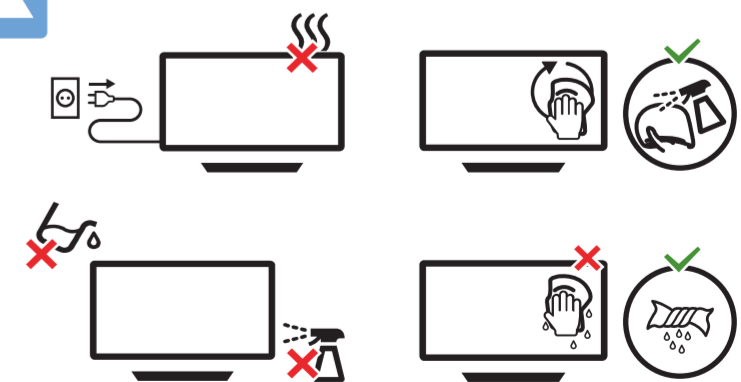
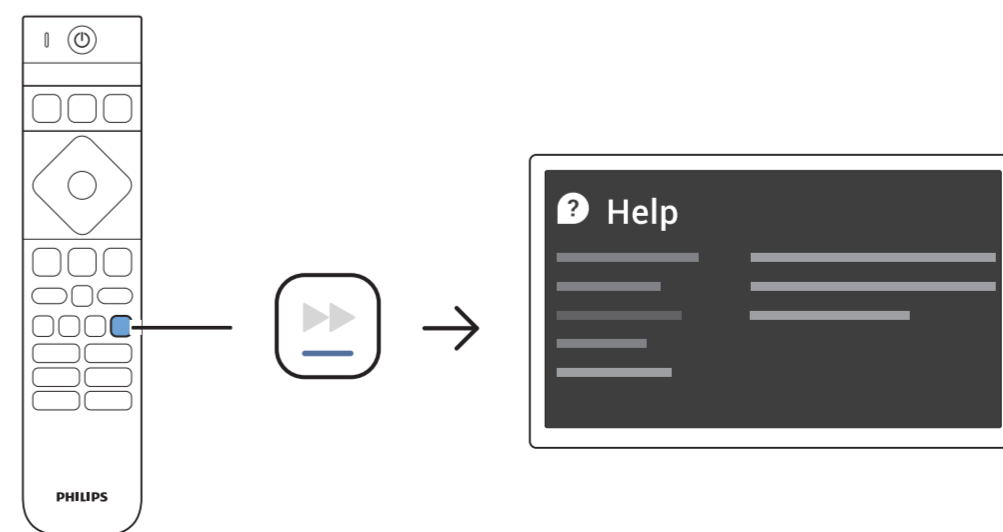
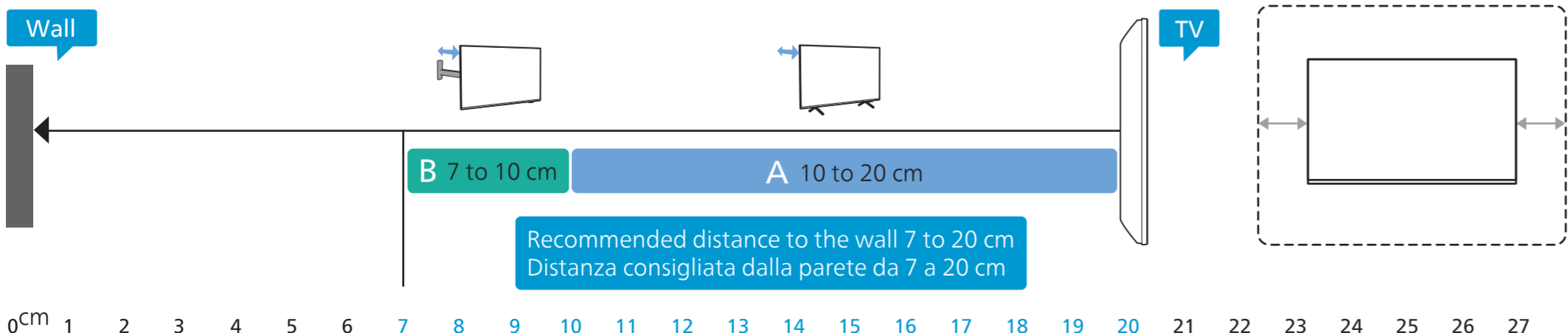

All registered and unregistered trademarks are property of their respective owners. Specifications are subject to change without notice. Philips and the Philips' shield emblem are trademarks of Koninklijke Philips N.V. and are used under license from Koninklijke Philips N.V. This product has been manufactured by and is sold under the responsibility of TP Vision Europe B.V. and TP Vision Europe B.V. is the warrantor in relation to this product. 2024 © TP Vision Europe B.V. All rights reserved. www.philips.com/welcome