

PHILIPS

Quick Start Guide

Micro music system

BTM2560
BTM2585



Register your product and get support at www.philips.com/support

1

2

1

2

1

2

3

BTM2560
BTM2585



www.philips.com/support



Specifications are subject to change without notice. This product has been manufactured by, and is sold under the responsibility of Gibson Innovations Ltd., and Gibson Innovations Ltd. is the warrantor in relation to this product. Philips and the Philips Shield Emblem are registered trademarks of Koninklijke Philips N.V. and are used under license.

BTM2560_2585_12_QSG_V1.0



1

2

3

4

5

6

1

2

3

4

BTM2560
BTM2585

1

2

BTM2560
BTM2585

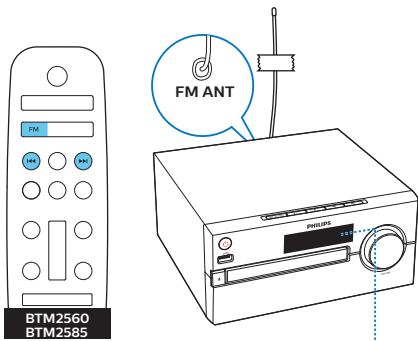

1 FM

2 A ◀◀/▶▶

2 B ◀◀/▶▶

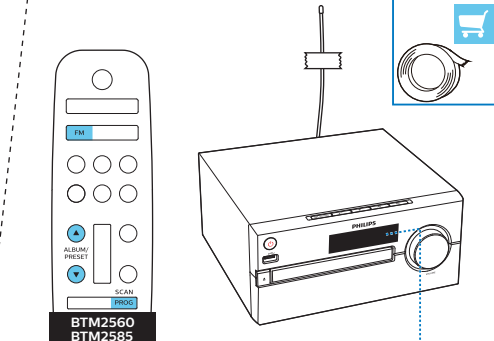

1 FM

2 SCAN
PROG

3 ▲/▼



1 [USB icon]

2 AUDIO IN USB

3 [Play icon]



1 [3.5mm Stereo Cable]

2 AUDIO IN USB

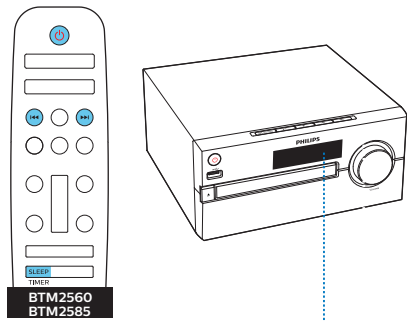

1 [Power icon]

2 SLEEP TIMER

3 ◀◀/▶▶

4 SLEEP TIMER

5 ◀◀/▶▶

6 SLEEP TIMER

7 ◀◀/▶▶

8 ◀◀/▶▶

9 SLEEP TIMER

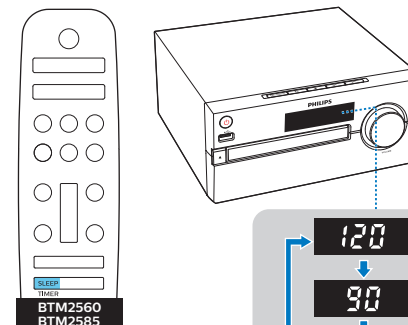

SLEEP TIMER



1 [USB icon]

